

Biosafety Cabinet Class I HUYAir Bio1 Elite

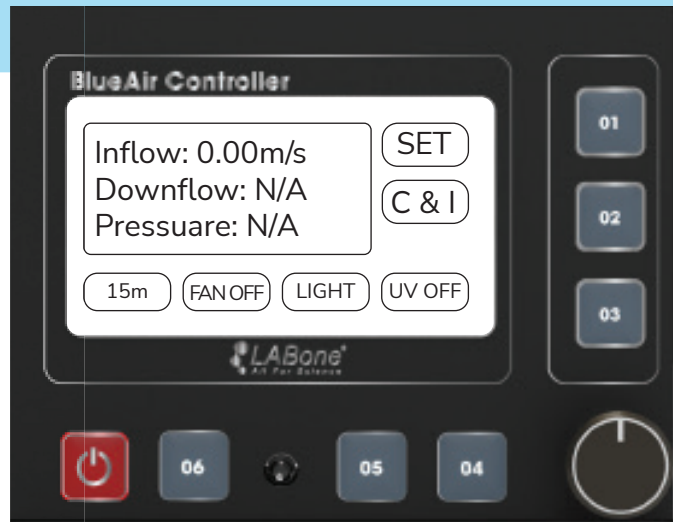

ELECTRICAL SAFETY WARNING

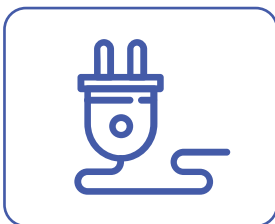

The HUYAir Bio1 Elite | Biosafety Cabinet Class 1 operates correctly and safely when used with the rated electrical supply. Please note that you should provide a power source with the appropriate voltage and frequency, which is **220V/50-60Hz** for the equipment before usage to ensure optimal performance and to avoid any electrical-related risks

CHEMICAL SPILL HANDLING INSTRUCTIONS

- ▶ If possible, cease work to prevent the spill from spreading or contaminating other areas.
- ▶ Wear appropriate protective equipment and then inspect the spill or chemical leak location to ensure the safety of the handler and the surrounding environment.
- ▶ Remove shelves from the chemical spill incident and carefully clean the agent to prevent pollution and ensure environmental safety.

QUICK OPERATING INSTRUCTIONS

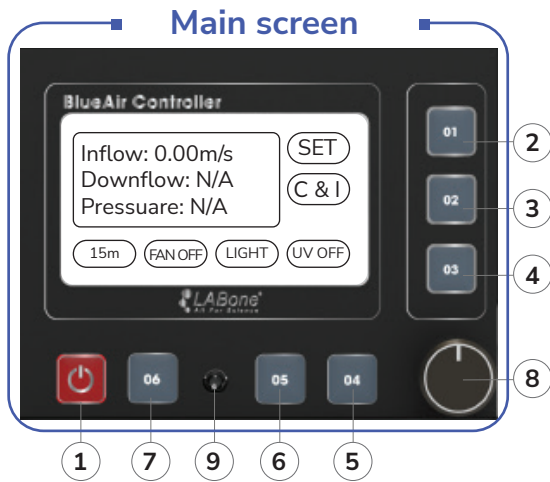

1. **ON/OFF Button:** Power On/Off.
2. **Button 1:** Parameter Adjustment (SET).
3. **Button 2:** C&I Button.
4. **Button 3:** Back (BACK).
5. **Button 4:** UV Light.
6. **Button 5:** Lighting (LIGHT) Button.
7. **Button 6:** Fan On/Off.
8. **SELECT Button:** Increase or decrease device parameters, and when pressed, the adjusted parameters will be saved.
9. **Indicator Lights:** Indicate the device's status. When operating normally, the light will be green, and it will change color to indicate warnings or errors.

**When in the on state, the device's status button on the screen lights up.*

SETTING | SPECIFICATIONS OF THE FAN

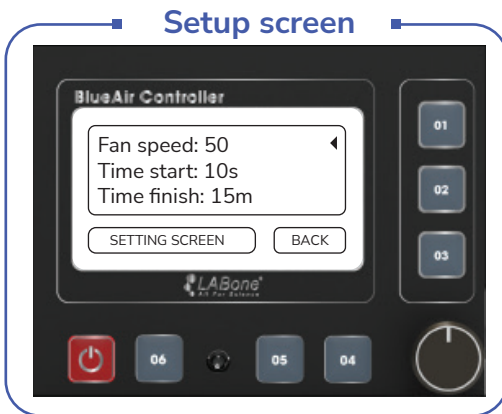

Step 1: Press button 01 (SET) on the main screen interface | display the setup screen.

Step 2: Rotate the Select knob to choose the FAN SPEED item you want to adjust the fan parameters for.

Step 3: Press the Select button to enter the parameter settings - Display parameter screen.

- Current Line: The current value.
- Set Line: The value being adjusted.

Step 4: Continue to turn the Select knob to change the value you want to adjust.

Step 5: Press the Select button to save the value.

Step 6: To return to the main screen, press the BACK button (button 3).

SETTING | UV LAMP SPECIFICATIONS

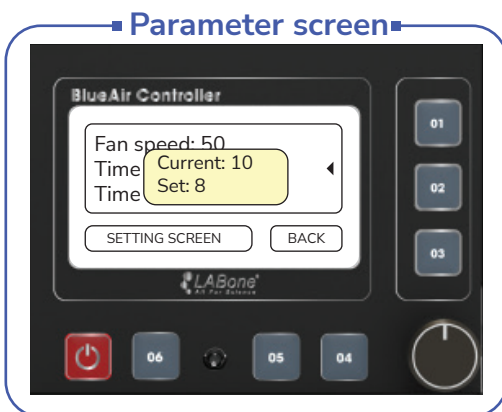

Step 1: Press button 01 (SET) on the main screen interface | display the setup screen.

TIME START: The UV lamp activation time from when the button is pressed ranges from 1s to 60s.

TIME FINISH: The UV lamp operating time until it automatically turns off ranges from 1m to 240m.

Step 2: Rotate the Select knob to choose the parameter you want to adjust.

Step 3: Press the Select button to enter parameter setup - Parameter display screen.

- Current Line: The current value.
- Set Line: The value being adjusted.

Step 4: Continue to rotate the Select knob to change the value to the desired setting.

Step 5: Press the Select button to save the value.

Step 6: To return to the main screen, press the BACK button (button 3).

- **NOTE:** The UV lamp only operates when the operation door is completely closed, and at that time, the lamp will illuminate, and the fan will turn off.